

AI Cabinet Designs

Spec Book
Value & Design Series



Product Overview

- * ALL carcasses are plywood construction
- * ALL drawer boxes are dovetailed hard wood boxes (1/2")
- * ALL drawer glides are full-extension and soft close
- * ALL hinges are soft close, nickel plated, 6-way adjustable, and frame mounted
- * ALL face frames are 3/4" solid wood
- * ALL doors and drawer fronts are 3/4"
- * ALL doors and drawer fronts are stained or painted solid wood
(Exception: Value Series Shaker styles and center panels of Value Series Raised Panel styles are Paint-Grade MDF)
- * ALL shelves are 3/4" plywood (veneered edges)
- * ALL exposed surfaces are UV coated
- * ALL door & drawer fronts are full overlay
- * ALL wall cabinets are invertible
- * ALL cabinets have a maximum width of 36" without center stiles (Exception: vanity combo VC48 & VC60)
- * The Stanford finish (WKA) has "applied molding" which may require a minimum extra 5/8" - 3/4" filler at corners or when multiple depth cabinets about in a straight run so the door opens completely
- * ALL lines have 5-piece drawer fronts (Exception: our Hickory Shaker finish has slab-front top drawer fronts)



Cabinet Construction

Pocket Screw Construction

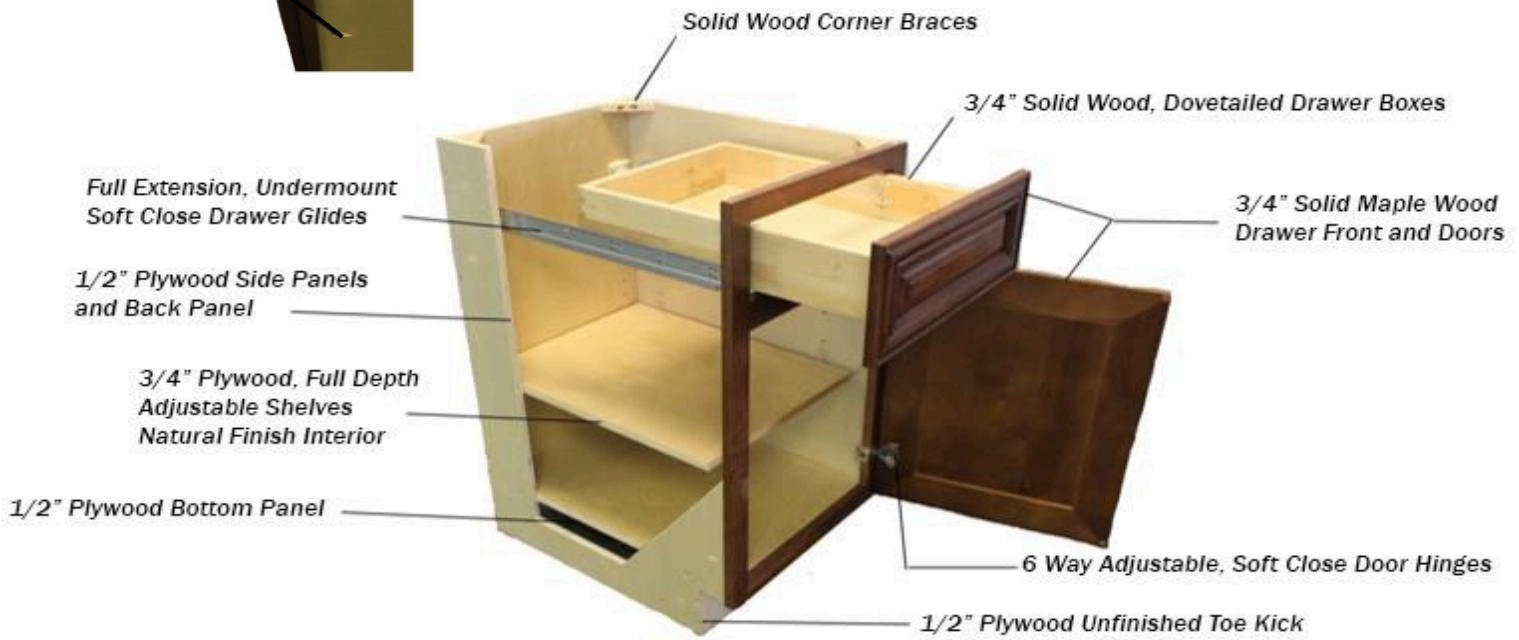
Pocket Screw Construction

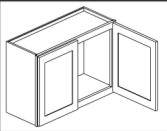
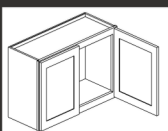
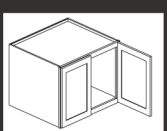
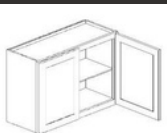
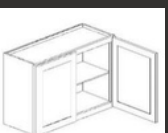

BRIDGE CABINETS

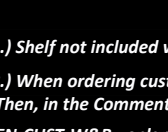
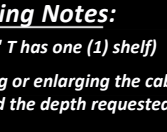
Bridge Cabinet - 2 doors			Bridge Cabinet - 2 doors			Refrigerator Cabinet - 2 doors		
	W3012	30" W 12" T 12" D		W3012-15	30" W 12" T 15" D		W3012-24	30" W 12" T 24" D
	W3015	30" W 15" T 12" D		W3015-15	30" W 15" T 15" D		W3015-24	30" W 15" T 24" D
	W3018	30" W 18" T 12" D		W3018-15	30" W 18" T 15" D		W3018-24	30" W 18" T 24" D
	W3021	30" W 21" T 12" D		W3021-15	30" W 21" T 15" D		W3021-24	30" W 21" T 24" D
	W3024	30" W 24" T 12" D		W3024-15	30" W 24" T 15" D		W3024-24	30" W 24" T 24" D
	W3315	33" W 15" T 12" D		W3315-15	33" W 15" T 15" D		W3315-24	33" W 15" T 24" D
	W3318	33" W 18" T 12" D		W3318-15	33" W 18" T 15" D		W3318-24	33" W 18" T 24" D
	W3612	36" W 12" T 12" D		W3612-15	36" W 12" T 15" D		W3612-24	36" W 12" T 24" D
	W3615	36" W 15" T 12" D		W3615-15	36" W 15" T 15" D		W3615-24	36" W 15" T 24" D
	W3618	36" W 18" T 12" D		W3618-15	36" W 18" T 15" D		W3618-24	36" W 18" T 24" D
	W3621	36" W 21" T 12" D		W3621-15	36" W 21" T 15" D		W3621-24	36" W 21" T 24" D
	W3624	36" W 24" T 12" D		W3624-15	36" W 24" T 15" D		W3624-24	36" W 24" T 24" D
	W3924	39" W 24" T 12" D		W3924-15	39" W 24" T 15" D		W3924-24	39" W 24" T 24" D

Ordering Notes:

- 1.) Shelf not included with Bridge Cabinets (Exception: 24" T has one (1) shelf)
- 2.) When ordering custom sizes, enter the SKU for reducing or enlarging the cabinet into the Accessories column. Then, in the Comments section, enter the cabinet SKU and the depth requested.
EN-CUST-W&B - enlarge to more than 12" deep
RE-CUST-W&B - reduce to less than 12" deep
- 3.) Any depth-modified cabinets (including WXXXX-15 and WXXXX-24) are not returnable.

SINGLE DOOR WALL CABINETS

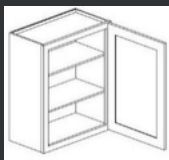
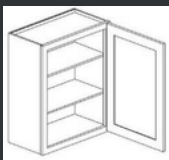
Wall Cabinets - 1 door			Wall Cabinets - 1 door		
	W0930	9" W 30" T 12" D		W0930-15	9" W 30" T 15" D
	W1230	12" W 30" T 12" D		W1230-15	12" W 30" T 15" D
	W1530	15" W 30" T 12" D		W1530-15	15" W 30" T 15" D
	W1830	18" W 30" T 12" D		W1830-15	18" W 30" T 15" D
	W2130	21" W 30" T 12" D		W2130-15	21" W 30" T 15" D
	W0936	9" W 36" T 12" D		W0936-15	9" W 36" T 15" D
	W1236	12" W 36" T 12" D		W1236-15	12" W 36" T 15" D
	W1536	15" W 36" T 12" D		W1536-15	15" W 36" T 15" D
	W1836	18" W 36" T 12" D		W1836-15	18" W 36" T 15" D
	W2136	21" W 36" T 12" D		W2136-15	21" W 36" T 15" D
W0942	9" W 42" T 12" D	W0942-15	9" W 42" T 15" D		
W1242	12" W 42" T 12" D	W1242-15	12" W 42" T 15" D		
W1542	15" W 42" T 12" D	W1542-15	15" W 42" T 15" D		
W1842	18" W 42" T 12" D	W1842-15	18" W 42" T 15" D		
W2142	21" W 42" T 12" D	W2142-15	21" W 42" T 15" D		

Ordering Notes:

- 1.) Two (2) shelves included (Exception: 42" T has 3 shelves)
- 2.) When ordering custom sizes, enter the SKU for reducing or enlarging the cabinet into the Accessories column. Then, in the Comments section, enter the cabinet SKU and the depth requested.

EN-CUST-W&B - enlarge to more than 12" deep
RE-CUST-W&B - reduce to less than 12" deep

- 3.) Any depth-modified cabinets (including WXXXX-15) are not returnable.

DOUBLE DOOR WALL CABINETS

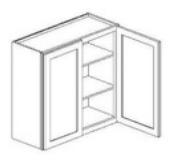
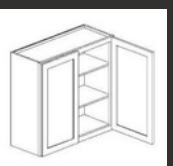
Wall Cabinets - 2 doors			Wall Cabinets - 2 doors		
	W2430	24" W 30" T 12" D		W2430-15	24" W 30" T 15" D
	W2730	27" W 30" T 12" D		W2730-15	27" W 30" T 15" D
	W3030	30" W 30" T 12" D		W3030-15	30" W 30" T 15" D
	W3330	33" W 30" T 12" D		W3330-15	33" W 30" T 15" D
	W3630	36" W 30" T 12" D		W3630-15	36" W 30" T 15" D
	W2436	24" W 36" T 12" D		W2436-15	24" W 36" T 15" D
	W2736	27" W 36" T 12" D		W2736-15	27" W 36" T 15" D
	W3036	30" W 36" T 12" D		W3036-15	30" W 36" T 15" D
	W3336	33" W 36" T 12" D		W3336-15	33" W 36" T 15" D
	W3636	36" W 36" T 12" D		W3636-15	36" W 36" T 15" D
	W2442	24" W 42" T 12" D		W2442-15	24" W 42" T 15" D
	W2742	27" W 42" T 12" D		W2742-15	27" W 42" T 15" D
	W3042	30" W 42" T 12" D		W3042-15	30" W 42" T 15" D
	W3342	33" W 42" T 12" D		W3342-15	33" W 42" T 15" D
	W3642	36" W 42" T 12" D		W3642-15	36" W 42" T 15" D

Ordering Notes:

- 1.) Two (2) shelves included (Exception: 42" T has 3 shelves)
- 2.) Cabinets have two doors with NO center stiles
- 3.) When ordering custom sizes, enter the SKU for reducing or enlarging the cabinet into the Accessories column. Then, in the Comments section, enter the cabinet SKU and the depth requested.
EN-CUST-W&B - enlarge to more than 12" deep
RE-CUST-W&B - reduce to less than 12" deep
- 4.) Any depth-modified cabinets (including WXXXX-15) are not returnable.

CORNER & END WALL CABINETS

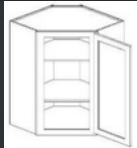
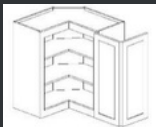
Wall Diagonal Corner Cabinet			Wall Diagonal Corner Cabinet			EZ-Reach Corner Wall Cabinet		
	WDC2430 WDC2436 WDC2442	24" W 30" T 12" D 24" W 36" T 12" D 24" W 42" T 12" D		WDC2736 WDC2742	27" W 36" T 15" D 27" W 42" T 15" D		WEZ2430 WEZ2436 WEZ2442	24" W 30" T 12" D 24" W 36" T 12" D 24" W 42" T 12" D

Ordering Notes:

1.) WDC and WEZ cabinets cannot be depth-modified

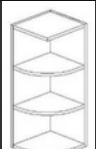
Wall Blind Corner Cabinet			Wall End Shelf		
	WBC2830 WBC2836 WBC2842	27" W 30" T 12" D 27" W 36" T 12" D 27" W 42" T 12" D		WES1230 WES1236 WES1242	12" W 30" T 12" D 12" W 36" T 12" D 12" W 42" T 12" D

Ordering Notes:

- 1.) Cabinet should be set 28" from wall corner
- 2.) Overall cabinet length is 27" (1" out from corner)
- 3.) Extra WF3 filler included with WBC28XX
- 4.) Door face is the same as a W15XX

Ordering Notes:

- 1.) Three (3) fixed 18mm hardwood shelves included
- 2.) Finished to match

SPECIALTY UPPER CABINETS

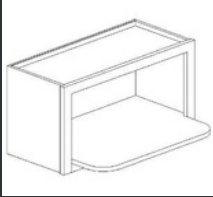
Wine Rack	Microwave Shelf	Plate Rack
		
<p>WR3015 30" W 15" T 12" D</p>	<p>MC3018 30" W 18" T 18" D</p>	<p>PR3015 30" W 15" T 12" D</p>

Ordering Notes:

- 1.) Mounts below a 30" wide cabinet
- 2.) May be mounted vertically or horizontally as a wall or base accessory cabinet. Order extra skins to finish ends
- 3.) Standard matching interior
- 4.) 11 full-size slots + 2 that are 90% accessible

Ordering Notes:

- 1.) Mounts below a 30" wide cabinet
- 2.) Finished opening: 26 7/8" W 14 1/4" T 17 1/4" D
- 3.) Standard matching interior
- 4.) 3/4" shelf comes out 18" from wall

Ordering Notes:

- 1.) Mounts below a 30" wide cabinet
- 2.) Twelve (12) usable slots
- 3.) Standard matching interior

Stem Glass Holder

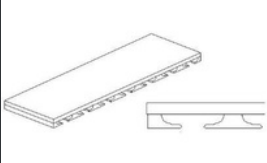
	<p>SGH30 30" W 1" T 12" D</p>
---	--

Ordering Notes:

- 1.) Mounts below a 30" wide cabinet
- 2.) Hangs approximately 1" below the cabinet
- 3.) Six (6) slots for glasses (will hold 12-18 glasses)

BASE & SINK BASE CABINETS

Base - 1 Full-Height Door

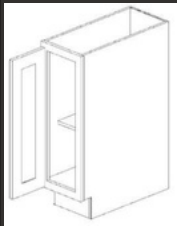

B09	9" W 34 1/2" T 24" D
B12-FH	12" W 34 1/2" T 24" D
B15-FH	15" W 34 1/2" T 24" D
B18-FH	18" W 34 1/2" T 24" D
B21-FH	21" W 34 1/2" T 24" D

Base - 2 Full-Height Doors



B24-FH	24" W 34 1/2" T 24" D
B27-FH	27" W 34 1/2" T 24" D
B30-FH	30" W 34 1/2" T 24" D
B33-FH	33" W 34 1/2" T 24" D
B36-FH	36" W 34 1/2" T 24" D

Ordering Notes:

1.) All BXX-FH come with only one (1) shelf

Base - 1 Door and 1 Drawer

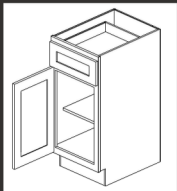

B12	12" W 34 1/2" T 24" D
B15	15" W 34 1/2" T 24" D
B18	18" W 34 1/2" T 24" D
B21	21" W 34 1/2" T 24" D

Base - 2 Doors and 1 Drawer

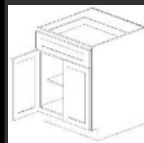

B24	24" W 34 1/2" T 24" D
B27	27" W 34 1/2" T 24" D
B30	30" W 34 1/2" T 24" D
B33	33" W 34 1/2" T 24" D
B36	36" W 34 1/2" T 24" D

Ordering Notes:

1.) All BXX come with only one (1) shelf

BASE & SINK BASE CABINETS (cont.)

Sink Base - 2 Full-Height Doors



SB24-FH	24" W 34 1/2" T 24" D
SB27-FH	27" W 34 1/2" T 24" D
SB30-FH	30" W 34 1/2" T 24" D
SB33-FH	33" W 34 1/2" T 24" D
SB36-FH	36" W 34 1/2" T 24" D

Ordering Notes:

1.) Shelf not included

Sink Base - 2 Doors and 1 False Drawer

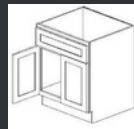

SB24	24" W 34 1/2" T 24" D
SB27	27" W 34 1/2" T 24" D
SB30	30" W 34 1/2" T 24" D
SB33	33" W 34 1/2" T 24" D
SB36	36" W 34 1/2" T 24" D

Ordering Notes:

1.) Shelf not included

Farm Sink Base - 2 Doors

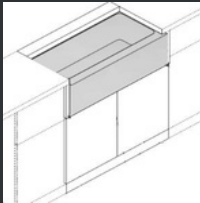

FSB3318	33" W 34 1/2" T 24" D
FSB3618	36" W 34 1/2" T 24" D
FSB3621	36" W 34 1/2" T 24" D
FSB3624	36" W 34 1/2" T 24" D

Ordering Notes:

1.) One 3" filler included (add additional fillers under Accessories)

FSB3318: Door height is 18"

FSB3618: Door height is 18"

FSB3621: Door height is 21"

FSB3624: Door height is 24"

2.) Full carcass height is 30". (Ex: FSB3621 has 9" of space from top of face frame to top of carcass)

Corner Sink Base - 1 Door and 1 False Drawer

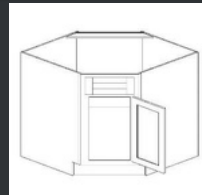

CSB36	36" X 36"
CSB36-FH	(one door, 15" wide)
CSB42	42" X 42"
CSB42-FH	(two doors, 24" wide)

Ordering Notes:

1.) Shelf not included

2.) Available with a false drawer front/door(s) or full-height door(s)

BASE CABINETS WITH ROLL-OUT TRAYS (ROT_s)

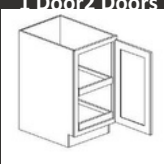
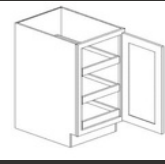
Base - 1 or 2 Full-Height Doors and 1 ROT		Base - 1 or 2 Full-Height Doors and 2 ROTs		Base - 1 or 2 Full-Height Doors and 3 ROTs				
	<p>1 Door</p> <p>B12-FH-ROT-1 B15-FH-ROT-1 B18-FH-ROT-1 B21-FH-ROT-1</p>	<p>2 Doors</p> <p>B24-FH-ROT-1 B27-FH-ROT-1 B30-FH-ROT-1 B33-FH-ROT-1 B36-FH-ROT-1</p>		<p>1 Door</p> <p>B12-FH-ROT-2 B15-FH-ROT-2 B18-FH-ROT-2 B21-FH-ROT-2</p>	<p>2 Doors</p> <p>B24-FH-ROT-2 B27-FH-ROT-2 B30-FH-ROT-2 B33-FH-ROT-2 B36-FH-ROT-2</p>		<p>1 Door</p> <p>B12-FH-ROT-3 B15-FH-ROT-3 B18-FH-ROT-3 B21-FH-ROT-3</p>	<p>2 Doors</p> <p>B24-FH-ROT-3 B27-FH-ROT-3 B30-FH-ROT-3 B33-FH-ROT-3 B36-FH-ROT-3</p>

Ordering Notes:

- 1.) One (1) ROT will be mounted level on the cabinet bottom
 - 2.) ~~Two (2) ROTs~~ Two (2) ROTs will be mounted on the bottom & at shelf level (same as drawer bank 2 lower drawers)
 - 3.) Three (3) ROTs will be mounted on the bottom, at shelf level, and at drawer level (same as a drawer bank)
- *To order ROTs separately, see Accessories (p.21)*

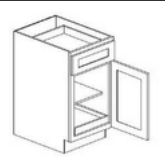
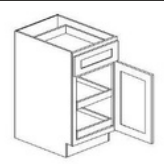
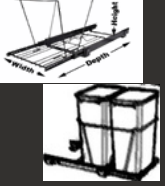
Base - 1 or 2 Doors, 1 Drawer, and 1 ROT		Base - 1 or 2 Doors, 1 Drawer, and 2 ROTs		Trash Pull-Out Cabinet				
	<p>1 Door</p> <p>B12-ROT-1 B15-ROT-1 B18-ROT-1 B21-ROT-1</p>	<p>2 Doors</p> <p>B24-ROT-1 B27-ROT-1 B30-ROT-1 B33-ROT-1 B36-ROT-1</p>		<p>1 Door</p> <p>B12-ROT-2 B15-ROT-2 B18-ROT-2 B21-ROT-2</p>	<p>2 Doors</p> <p>B24-ROT-2 B27-ROT-2 B30-ROT-2 B33-ROT-2 B36-ROT-2</p>		<p>1 Door, 1 Drawer</p> <p>B15-TRASH-SC B18-TRASH-SC B21-TRASH-SC</p>	<p>Full-Height Door</p> <p>B15-FH-TRASH-SC B18-FH-TRASH-SC B21-FH-TRASH-SC</p>

Ordering Notes:

- 1.) One (1) ROT will be mounted level on the cabinet
 - 2.) Two (2) ROTs will be mounted on the bottom &
- *To order ROTs separately, see Accessories (p.21) at shelf level*
- 1.) B15 comes with one (1) trash can; B18 and B21 come with two (2) trash cans
 - 2.) Trash Kits will be mounted unattached to the hinged door. Mounting brackets will be supplied.

SPICE RACK & DRAWER BANK CABINETS

Base Spice Rack

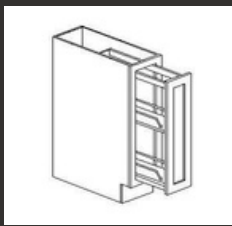

BSR09

9" W 34 1/2" T 24" D

Ordering Notes:

- 1.) Spice Rack has 3 adjustable shelves
- 2.) Spice Rack size: 5" W 25.5" H 23.5" D

Drawer Bank Base - 3 Drawers

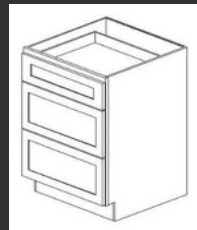

3DB12

12" W 34 1/2" T 24" D

3DB15

15" W 34 1/2" T 24" D

3DB18

18" W 34 1/2" T 24" D

3DB21

21" W 34 1/2" T 24" D

3DB24

24" W 34 1/2" T 24" D

3DB27

27" W 34 1/2" T 24" D

3DB30

30" W 34 1/2" T 24" D

3DB33

33" W 34 1/2" T 24" D

3DB36

36" W 34 1/2" T 24" D

Ordering Notes:

- 1.) Top drawer front: 7 3/16" Tall; bottom two drawers fronts: 10 11/16" Tall
- 2.) Drawer box depth: Top - 3 3/16" deep inside, 4" drawer box height; Bottom two - 6 5/16" deep inside, 7 1/8" drawer box height

Drawer Bank Base - 2 Drawers

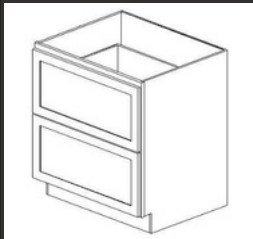

2DB30

30" W 34 1/2" T 24" D

2DB36

36" W 34 1/2" T 24" D

Ordering Notes:

- 1.) Each drawer front is 14 1/2" Tall
- 2.) Drawer box depth: 9 1/8" deep inside, 10" drawer box height

Cabinet Drawer Bench

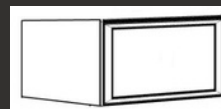

CDB3009

30" W 09" T 24" D

CDB3012

30" W 12" T 24" D

CDB3015

30" W 15" T 24" D

CDB3018

30" W 18" T 24" D

CDB3021

30" W 21" T 24" D

CDB3609

36" W 09" T 24" D

CDB3612

36" W 12" T 24" D

CDB3615

36" W 15" T 24" D

CDB3618

36" W 18" T 24" D

CDB3621

36" W 21" T 24" D

TOE DRAWER CABINETS

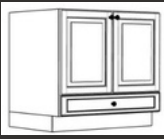
Base - 1 Door and 1 Toe Drawer			Base - 2 Doors and 1 Toe Drawer		
	<p>B12-TD</p> <p>B15-TD</p> <p>B18-TD</p> <p>B21-TD</p>	<p>12"W 34 1/2"T 24"D</p> <p>15"W 34 1/2"T 24"D</p> <p>18"W 34 1/2"T 24"D</p> <p>21"W 34 1/2"T 24"D</p>		<p>B24-TD</p> <p>B27-TD</p> <p>B30-TD</p> <p>B33-TD</p> <p>B36-TD</p>	<p>24"W 34 1/2"T 24"D</p> <p>27"W 34 1/2"T 24"D</p> <p>30"W 34 1/2"T 24"D</p> <p>33"W 34 1/2"T 24"D</p> <p>36"W 34 1/2"T 24"D</p>

Ordering Notes:

1.) Toe Drawer cabinets can be used as sink bases or microwave cabinets

BASE CORNER CABINETS

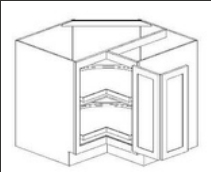
Lazy Susan (EZ-Reach Base w/Lazy Susan apparatus)		
	<p>LS33</p> <p>LS36</p>	<p>9" doors, 33" backs, 24" sides</p> <p>12" doors, 36" backs, 24" sides</p>

Ordering Notes:

1.) Comes with two (2) wooden Lazy Susan discs

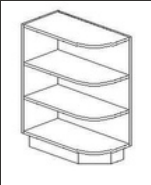
Base End Open Shelf		
	<p>BES12</p>	<p>12" W 24" D</p>

Ordering Notes:

- 1.) Please specify right or left end in the Comments section
- 2.) Unit has three (3) shelves. The top most is counter top sub deck.

BLIND CORNER BASE CABINETS

Blind Corner Base 37-40

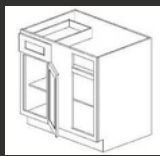

BBC37-40

27"W 34 1/2" T 24"D
(uses a 27" carcass)

Blind Corner Base 40-43

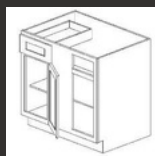

BBC40-43

36"W 34 1/2" T 24"D
(uses a 36" carcass)

Ordering Notes:

- 1.) Door & Drawer: 12" (B12); please specify RIGHT or LEFT blind in the Comments section of your order form
- 2.) Center Stile 6" Usable PULL = 3"
- 3.) BF3 filler included

Ordering Notes:

- 1.) Door & Drawer: 15" (B15); please specify RIGHT or LEFT blind in the Comments section of your order form
- 2.) Center Stile 9" Usable PULL = 3"
- 3.) BF6 filler included

PANTRY CABINETS

2-Door Pantry

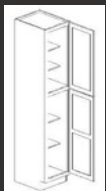

UP1884
UP1890
UP1896

18" W 84" T 24" D
18" W 90" T 24" D
18" W 96" T 24" D

4-Door Pantry

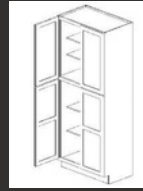

UP2484
UP2490
UP2496

24" W 84" T 24" D
24" W 90" T 24" D
24" W 96" T 24" D

UP3084
UP3090
UP3096

30" W 84" T 24" D
30" W 90" T 24" D
30" W 96" T 24" D

- 1.) Upper door: 84"=30" door; 90"=36" door; 96"=42" door
- 2.) Shelves: 84" - 2 shelves; 90" and 96" - 3 shelves
- 3.) Bottom door is always 54" from floor
- 4.) Any depth-modified cabinets are not returnable.

Ordering Notes:

- 5.) When ordering custom sizes, enter the SKU for reducing or enlarging the cabinet into the Accessories column. Then, in the Comments section, enter the cabinet SKU and the depth requested.

EN-CUST-O&P - enlarge to more than 24" deep
RE-CUST-O&P - reduce to less than 24" deep

PANTRY CABINETS WITH ROTs

2-Door Pantry with ROTs

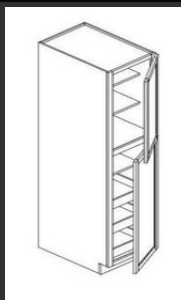

UP1884-ROT-1	18" W 84" T 24" D
UP1890-ROT-1	18" W 90" T 24" D
UP1896-ROT-1	18" W 96" T 24" D
UP1884-ROT-2	18" W 84" T 24" D
UP1890-ROT-2	18" W 90" T 24" D
UP1896-ROT-2	18" W 96" T 24" D
UP1884-ROT-3	18" W 84" T 24" D
UP1890-ROT-3	18" W 90" T 24" D
UP1896-ROT-3	18" W 96" T 24" D

Ordering Notes:

- 1.) Upper door: 84"=30" door; 90"=36" door; 96"=42" door
- 2.) Shelves: one (1) shelf included
- 3.) ROTs will be mounted at the same heights as a drawer bank

4-Door Pantry with ROTs

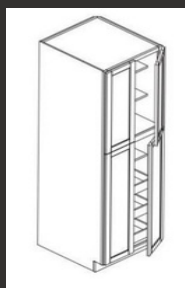

UP2484-ROT-1	24" W 84" T 24" D
UP2490-ROT-1	24" W 90" T 24" D
UP2496-ROT-1	24" W 96" T 24" D
UP2484-ROT-2	24" W 84" T 24" D
UP2490-ROT-2	24" W 90" T 24" D
UP2496-ROT-2	24" W 96" T 24" D
UP2484-ROT-3	24" W 84" T 24" D
UP2490-ROT-3	24" W 90" T 24" D
UP2496-ROT-3	24" W 96" T 24" D

Ordering Notes:

- 1.) Upper door: 84"=30" door; 90"=36" door; 96"=42" door
- 2.) Shelves: one (1) shelf included
- 3.) ROTs will be mounted at the same heights as a drawer bank

4-Door Pantry with ROTs

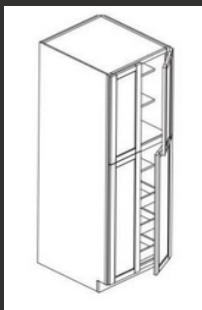

UP3084-ROT-1	30" W 84" T 24" D
UP3090-ROT-1	30" W 90" T 24" D
UP3096-ROT-1	30" W 96" T 24" D
UP3084-ROT-2	30" W 84" T 24" D
UP3090-ROT-2	30" W 90" T 24" D
UP3096-ROT-2	30" W 96" T 24" D
UP3084-ROT-3	30" W 84" T 24" D
UP3090-ROT-3	30" W 90" T 24" D
UP3096-ROT-3	30" W 96" T 24" D

Ordering Notes:

- 1.) Upper door: 84"=30" door; 90"=36" door; 96"=42" door
- 2.) Shelves: one (1) shelf included
- 3.) ROTs will be mounted at the same heights as a drawer bank

*To order ROTs separately, see Accessories (p.21)

*Additional shelves are available for purchase. On your order form, under Accessories, use part number SH18, SH24, or SH30, depending on pantry width.

OVEN CABINETS

Double Oven Cabinet

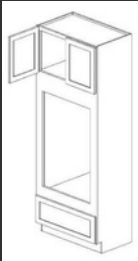



OVD3384	33" W 84" T 24" D
OVD3390	33" W 90" T 24" D
OVD3396	33" W 96" T 24" D

Ordering Notes:

- 1.) Factory opening = 27" W x 39 1/2" T
- 2.) Opening may be field-trimmed by the installer to 31" W x 49" T
- 3.) Drawer: one small drawer (no shelf included)

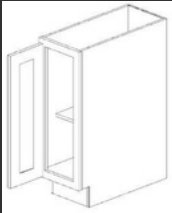
VANITY BASE CABINETS

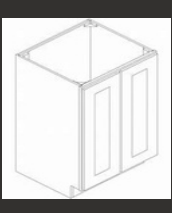
Vanity Base - 1 Full-Height Door			Vanity Base - 2 Full-Height Doors			Vanity Sink Base - 2 Full-Height Doors		
	VB09	9" W 34 1/2" T 21" D		VB24-FH	24" W 34 1/2" T 21" D		VSB24-FH	24" W 34 1/2" T 21" D
	VB12-FH	12" W 34 1/2" T 21" D		VB27-FH	27" W 34 1/2" T 21" D		VSB27-FH	27" W 34 1/2" T 21" D
	VB15-FH	15" W 34 1/2" T 21" D		VB30-FH	30" W 34 1/2" T 21" D		VSB30-FH	30" W 34 1/2" T 21" D
	VB18-FH	18" W 34 1/2" T 21" D		VB33-FH	33" W 34 1/2" T 21" D		VSB33-FH	33" W 34 1/2" T 21" D
	VB21-FH	21" W 34 1/2" T 21" D		VB36-FH	36" W 34 1/2" T 21" D		VSB36-FH	36" W 34 1/2" T 21" D

Ordering Notes:

1.) All VBXX-FH cabinets come with one (1) shelf

Ordering Notes:

1.) Shelf NOT included with any VSB cabinets

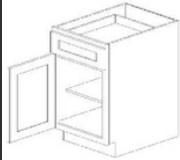
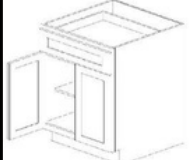
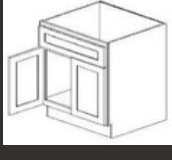
Vanity Base - 1 Door and 1 Drawer			Vanity Base - 2 Doors and 1 Drawer			Vanity Sink Base - 2 Doors and 1 False Drawer		
	VB12	12" W 34 1/2" T 21" D		VB24	24" W 34 1/2" T 21" D		VSB24	24" W 34 1/2" T 21" D
	VB15	15" W 34 1/2" T 21" D		VB27	27" W 34 1/2" T 21" D		VSB27	27" W 34 1/2" T 21" D
	VB18	18" W 34 1/2" T 21" D		VB30	30" W 34 1/2" T 21" D		VSB30	30" W 34 1/2" T 21" D
	VB21	21" W 34 1/2" T 21" D		VB33	33" W 34 1/2" T 21" D		VSB33	33" W 34 1/2" T 21" D
			VB36	36" W 34 1/2" T 21" D	VSB36	36" W 34 1/2" T 21" D		

Ordering Notes:

1.) All VBXX cabinets come with one (1) shelf

Ordering Notes:

1.) Shelf NOT included with any VSB cabinets

VANITY & DRAWER BANK CABINETS

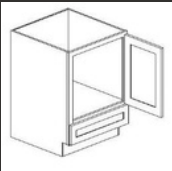
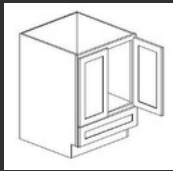
Vanity Base - 1 Door and 1 Toe Drawer			Vanity Base - 2 Door and 1 Toe Drawer		
	VB12-TD	12" W 34 1/2" T 21" D		VB24-TD	24" W 34 1/2" T 21" D
	VB15-TD	15" W 34 1/2" T 21" D		VB27-TD	27" W 34 1/2" T 21" D
	VB18-TD	18" W 34 1/2" T 21" D		VB30-TD	30" W 34 1/2" T 21" D
	VB21-TD	21" W 34 1/2" T 21" D		VB33-TD	33" W 34 1/2" T 21" D
				VB36-TD	36" W 34 1/2" T 21" D

Ordering Notes:

1.) Shelf **NOT** included with Toe Drawer cabinets 2.) One (1) operable drawer

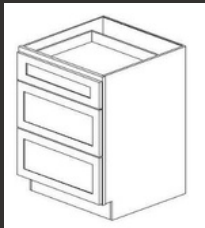
Vanity Drawer Bank Base - 3 Drawers		
	VDB12	12" W 34 1/2" T 21" D
	VDB15	15" W 34 1/2" T 21" D
	VDB18	18" W 34 1/2" T 21" D
	VDB21	21" W 34 1/2" T 21" D
	VDB24	24" W 34 1/2" T 21" D
	VDB27	27" W 34 1/2" T 21" D
	VDB30	30" W 34 1/2" T 21" D
	VDB33	33" W 34 1/2" T 21" D
VDB36	36" W 34 1/2" T 21" D	

Ordering Notes:

1.) Top drawer front: 7 3/16" Tall; bottom two drawers fronts: 10 11/16" Tall

2.) Drawer box depth: Top - 3 3/16" deep inside, 4" drawer box height; Bottom two - 6 5/16" deep inside, 7 1/8" drawer box height

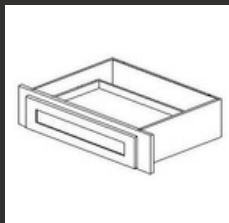
Vanity Knee Drawer		
	VKD30-36	36" W 6" T 21" D

Ordering Notes:

1.) Actual drawer is 30"W

2.) Face of drawer measures 36"W and can be field-cut down to 30"W

VANITY COMBINATION CABINETS

Vanity Combination Cabinet - 1 Door and 2 Drawers

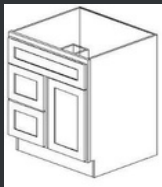

VC30D-R
VC30D-L

30"W 34 1/2"T 21"D

Ordering Notes:

- 1.) 30" false drawer front
- 2.) Two (2) usable 12" drawers
- 3.) One (1) 18" door
- 4.) R and L in part number designates DRAWER side when facing cabinet

Vanity Combination Cabinet - 2 Doors and 2 Drawers

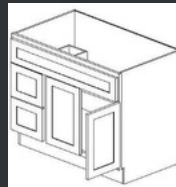

VC36D-R
VC36D-L

36"W 34 1/2"T 21"D

Ordering Notes:

- 1.) 36" false drawer front
- 2.) Two (2) usable 12" drawers
- 3.) Two (2) 12" doors
- 4.) R and L in part number designates DRAWER side when facing cabinet

Vanity Combination Cabinet - 2 Doors and 2 Drawers

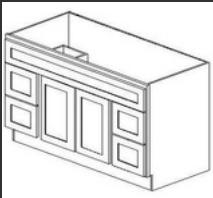

VC48D

48"W 34 1/2"T 21"D

Ordering Notes:

- 1.) 48" false drawer front
- 2.) Four (4) usable 12" drawers, two (2) on right and two (2) on left
- 3.) Two (2) 12" doors

Vanity Combination Cabinets - 2 Doors and 2 Drawers

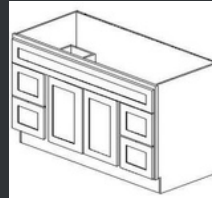

VC60D

60"W 34 1/2"T 21"D

Ordering Notes:

- 1.) 60" false drawer front
- 2.) Four (4) usable 12" drawers, two (2) on right and two (2) on left
- 3.) Two (2) 18" doors

VANITY PANTRY CABINETS

2-Door Pantry

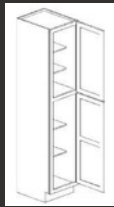

VUP1884	18" W 84" T 21" D
VUP1890	18" W 90" T 21" D
VUP1896	18" W 96" T 21" D

Ordering Notes:

- 1.) Upper door: 84"=30" door; 90"=36" door; 96"=42" door
- 2.) Shelves: 84" - 2 shelves; 90" and 96" - 3 shelves
- 3.) Bottom door is always 54" from floor

4-Door Pantry

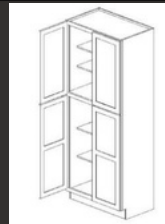



VUP2484	24" W 84" T 21" D
VUP2490	24" W 90" T 21" D
VUP2496	24" W 96" T 21" D
VUP3084	30" W 84" T 21" D
VUP3090	30" W 90" T 21" D
VUP3096	30" W 96" T 21" D

Ordering Notes:



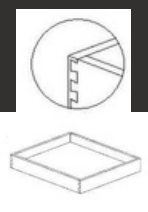

- 1.) Upper door: 84"=30" door; 90"=36" door; 96"=42" door
- 2.) Shelves: 84" - 2 shelves; 90" and 96" - 3 shelves
- 3.) Bottom door is always 54" from floor

ACCESSORIES

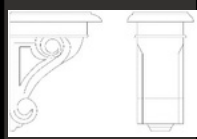

Touch-Up Kit			Soft Close Hinge			Dovetailed Solid Roll Out Trays (ROTs)		
	TUKIT	Includes: Putty Touch-up pen & Putty stick		SCH	Mounts to the Face Frame (item is per hinge)		ROT12 ROT15 ROT18 ROT21 ROT24 ROT27 ROT30 ROT33 ROT36	Tray 3" T x 21" D Tray 3" T x 21" D Tray 3" T x 21" D Tray 3" T x 21" D Tray 3" T x 21" D Tray 3" T x 21" D Tray 3" T x 21" D Tray 3" T x 21" D Tray 3" T x 21" D

Ordering Notes:

- 1.) Full-extension soft-close glides included
- 2.) The ROT size fits the intended cabinet: ROT15 = B15
- 3.) ROTs fit in standard 24" depth cabinets

Post			Corbel 1			Corbel 2 (Grape Leaf)		
	TP3 TP5	3" W 34 1/2" T 5" W 35 1/2" T		CORBEL1	5 1/2" W 6" D 9" T		CORBEL2	4 3/4" W 5 1/2" D 10 1/4" T
Post (Shaker Style)			Corbel #1 (Shaker Style)			Corbel #2 (Shaker Style)		
	TP3 TP5	3" W 34 1/2" T 5" W 35 1/2" T		CORBEL1	6 1/4" W 6 3/8" D 9" T		CORBEL2	4 3/4" W 5 1/8" D 10 1/4" T

ACCESSORIES (cont.)

Dishwasher Panel			Refrigerator Panel			Toe Kick		
	DWP	24" Depth		RP2496	24" Depth		TK 1/4	1/4" Thick
		34 1/2" Tall			96" Tall			96" Long
				RP3696	36" Depth		TK 1/2	1/2" Thick
					96" Tall			96" Long
								4 1/2" Tall

Ordering Notes:

- 1.) Each panel comes with a 3/4" thick 3" W filler
- 2.) Exterior finished to match (interior natural)

Ordering Notes:

- 1.) Each panel comes with a 3/4" thick 1.5" W filler
- 2.) Exterior finished to match (interior natural)

ACCESSORIES: DOORS, FILLERS & SKINS

False (Plant-On) Doors



BFD	23.5" W 29" T
VBFD	20.5" W 29" T
WFD1230	11.5" W 29.25" T
WFD1236	11.5" W 35.25" T
WFD1242	11.5" W 41.25" T

Ordering Notes:

1.) Attached through cabinet interior

Prepped for Glass



PREPPED DOOR

Door center panel removed for glass insert

Ordering Notes:

- 1.) CFA Cabinetry does NOT supply glass inserts
- 2.) Please specify in the Comments section which cabinet's doors should be prepped for glass

Wall & Base Fillers

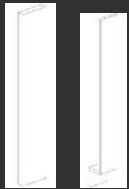

WF3	3" W 42" T
WF6	6" W 42" T
BF3	3" W 34 1/2" T
BF6	6" W 34 1/2" T
TF3	3" W 96" T
TF6	6" W 96" T

Ordering Notes:

- 1.) 3/4" solid material
- 2.) Base Fillers (BF3, BF6) have a built-in toe kick

Fluted Fillers



WFF30	3" W 30"
WFF36	T 3" W
WFF42	36" T 3"
	W 42" T
BFF	3" W 34 1/2" T

Ordering Notes:

- 1.) 2" plinth fixed at both top and bottom
- 2.) Base Filler (BFF) has a built-in toe kick

Skins

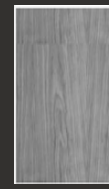

BSK3696	36" W 96" T
BSK4836	48" W 36" T
BSK9636	96" W 36" T
TSK	24" W 96" T
WSK	12" W 42" T
BSK	24" W 34 1/2" T

Ordering Notes:

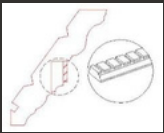
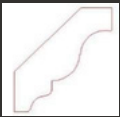

- 1.) 4mm thick veneer

ACCESSORIES: MOLDINGS

Large Crown Molding			Small Crown Molding			Light Rail Molding		
	CRM LG	3 1/4" T 96" L		CRM SM	2 1/8" T 96" L		LRM	1 7/8" T 96" L

Ordering Notes:

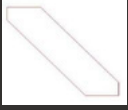
1.) Includes attached dentil, standard



Large Crown Molding (Shaker Style)			Small Crown Molding (Shaker Style)			Light Rail Molding (Shaker Style)		
	CRM LG	3 1/4" T 96" L		CRM SM	2 1/8" T 96" L		LRM	1 7/8" T 96" L

Ordering Notes:

1.) Shaker profile will automatically be sent when ordering Shaker cabinet lines

Soffit Crown Molding			Furniture Base Molding			Outside Corner Molding		
	SFC	3/4" T 3/4" W 96" L		FBM	3/4" T 4 1/2" W 96" L		OCM	3/4" T 3/4" W 96" L

ACCESSORIES: MOLDINGS (cont.)

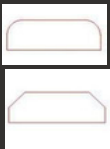
Soffit Crown Molding (Shaker Style)			Scribe Molding			Batten Molding		
	SFC	5/8" W 96" L		SCM	5/8" W 96" L		BM8	3/4" W 3/8" T 96" L

Ordering Notes:

1.) Shaker profile will automatically be sent when ordering Shaker cabinet lines

Ordering Notes:

1.) Shaker profile will automatically be sent when ordering Shaker cabinet lines

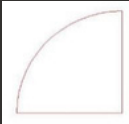
Quarter Round Molding		
	QRM	1 1/16" W 1 1/16" T 96" L

Base Filler Spice Rack		
	BFSR	3" W 30" T 23" D

Ordering Notes:

1.) 3" fluted filler included